

Product data sheet

Characteristics

ABL8MEM24006

Regulated Switch Power Supply, 1 or 2-phase,
100..240V AC, 24V, 0.6 A



Product availability: Stock - Normally stocked in distribution facility

Price*: 105.00 USD



Commercial status

This Product is Obsolete : FEB 17, 2021

This Product is Obsolete

Main

Range of Product	Modicon Power Supply
Product or Component Type	Power supply
Power supply type	Regulated switch mode
Input voltage	100...240 V AC phase to phase L1-L2 100...240 V AC single phase N-L1 120...250 V DC
Input voltage limits	85...264 V AC
Rated power in W	15 W
Output voltage	24 V DC
Power supply output current	0.6 A

Complementary

Input protection type	Integrated fuse (not interchangeable)
Inrush current	20 A
Power factor	0.5 at 24 V DC
Efficiency	80 %
Output voltage limits	22.2...28.8 V adjustable
Power dissipation in W	3.8 W
Current consumption	0.25 A 240 V AC 0.4 A 100 V AC
Residual ripple	250 mV
Output protection type	Thermal Against short-circuits
Connections - terminals	Screw type terminals 2 x 0.14...2 x 2.5 mm ² , AWG 26...AWG 14) input connection Screw type terminals 2 x 0.14...2 x 2.5 mm ² , AWG 26...AWG 14) output connection
Status LED	Output voltage 1 LED Green)
Maximum Depth	2.32 In (59 mm)
Maximum Height	3.94 In (100 mm)
Maximum Width	1.42 In (36 mm)

Net Weight	0.22 Lb(US) (0.1 kg)
Output coupling	Parallel Series
Marking	CE
Mounting support	35 x 7.5 mm symmetrical DIN rail Panel 2 screws, diameter : 4 mm 35 x 15 mm symmetrical DIN rail
Operating position	Vertical
Supply	SELV EN/IEC 60950-1 SELV EN/IEC 60204-1 SELV IEC 60364-4-41

Environment

Standards	UL 508 CSA C22.2 No 60950-1 EN/IEC 62368-1
Product certifications	TUV 60950-1 EAC KC RCM CCSAus CSA 22-2 No 950 CULus 508
Environmental characteristic	EMC EN 55022 Class B EMC EN 61000-6-3 EMC EN/IEC 61000-6-2 EMC EN/IEC 61204-3 Safety EN/IEC 60950-1
Operating altitude	2000 m
IP degree of protection	IP20 conforming to EN/IEC 60529
Ambient air temperature for operation	-13...131 °F (-25...55 °C) without) 131...158 °F (55...70 °C) with derating factor)
Ambient Air Temperature for Storage	-40...158 °F (-40...70 °C)
Relative Humidity	0...90 % during operation 0...95 % in storage
Electrical energy source class conforming- to IEC 62368-1	ES1
Dielectric strength	3000 V between input and output

Ordering and shipping details

Category	22525 - ABL8 AND ABL7 POWER SUPPLIE
Discount Schedule	CP12
GTIN	00785901490036
Nbr. of units in pkg.	1
Package weight(Lbs)	1 Lb(US) (0.45 kg)
Returnability	No
Country of origin	CN

Packing Units

Package 1 Height	0.500 Dm
Package 1 width	0.730 Dm
Package 1 Length	1.000 Dm

Offer Sustainability

Sustainable offer status	Green Premium product
California proposition 65	WARNING: This product can expose you to chemicals including: Lead and lead compounds, which is known to the State of California to cause cancer and birth defects or other reproductive harm. For more information go to www.P65Warnings.ca.gov
REACH Regulation	REACH Declaration
EU RoHS Directive	Pro-active compliance (Product out of EU RoHS legal scope) EU RoHS Declaration
Mercury free	Yes
RoHS exemption information	Yes
China RoHS Regulation	China RoHS Declaration
Environmental Disclosure	Product Environmental Profile
Circularity Profile	End Of Life Information
PVC free	Yes

Contractual warranty

Warranty	18 months
----------	-----------

Regulated Switch Mode Power Supplies

Dimensions

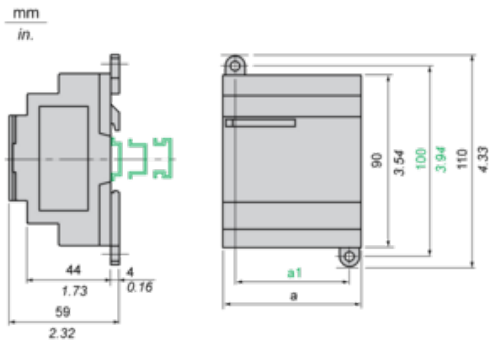

	a in mm	a in in.	a1 in mm	a1 in in.
ABL8MEM05040	54	2.12	42	1.65
ABL8MEM12020	54	2.12	42	1.65
ABL8MEM24003	36	1.41	24	0.94
ABL8MEM24006	36	1.41	24	0.94
ABL8MEM24012	54	2.12	42	1.65
ABL7RM24025	74	2.91	60	2.36

Regulated Switch Mode Power Supply

Internal Wiring Diagram

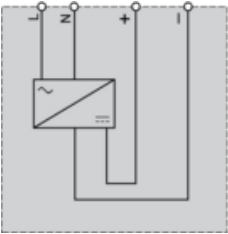

Regulated Switch Mode Power Supplies

Series or Parallel Connection

Series Connection

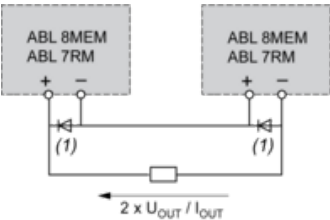

(1) Two Schottky diodes I_{min} = power supply I_n and V_{min} = 50 V

Parallel Connection

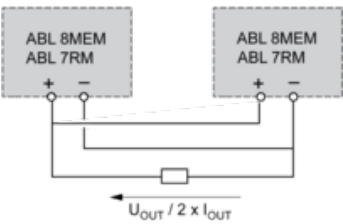

Family	Series	Parallel
ABL 7RM/8MEM	2 products max.	2 products max.

NOTE: Series or parallel connection is only recommended for products with identical references.

Regulated Switch Mode Power Supplies

Derating

The ambient temperature is a determining factor that limits the power an electronic power supply can deliver continuously. If the temperature around the electronic components is too high, their life will be significantly reduced.

The nominal ambient temperature for the Modular range of Phaseo power supplies is 55°C. Above this temperature, derating is necessary up to a maximum temperature of 70°C (except for the ABL7RM24025 model).

The graph below shows the power as a percentage of the nominal power that the power supply can deliver continuously, depending on the ambient temperature.

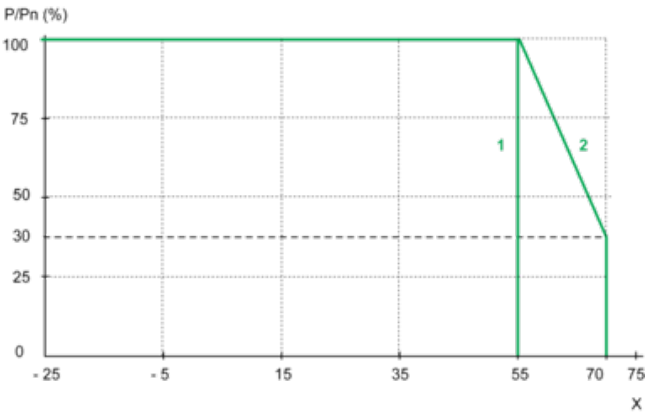

X Maximum operating temperature (°C)

(1) With an ABL7RM24025

(2) With an ABL8MEM series

Product Life Status : End of commercialisation

ABL8MEM24006 may be replaced by any of the following products:



ABLM1A24006
Regulated Power Supply, 100-240V AC, 24V 0.6 A, single phase, Modular
Qty 1
Substitution date: |